

Quick Start Guide

Preface
Thank you for buying the Speed Wi-Fi NEXT W06 (simply called "the product" from here on). Before using the product, be sure to read the "Quick Start Guide" (this manual) and "Notes on usage" to ensure correct use.

Packaged items
Before start using the product, make sure that you have all the following packaged with the product.

- **Speed Wi-Fi NEXT W06**
 - **USB Type-C to Micro B adapter (sample)**
Attach to a connector of USB cable (commercially available) as required when connecting the product to a PC etc.
 - **保証書 (本体) (Warranty (for main unit)) (Japanese)**
 - **Wi-Fi 初期設定 (Wi-Fi Initialization) sticker (Japanese)**
 - **はじめてガイド (Quick Start Guide) (Japanese)**
 - **ご利用にあたっての注意事項 (Notes on usage) (Japanese)**
- * The following items are not included.
● **AC adapter** ● **USB cable**

* Keep the included accessories including warranty at hand.
* Please purchase the specified charging equipment (sold separately).
* The battery is built into the product.
* Illustrations of the product in the descriptions are sample images. They may differ from the actual ones.

About descriptions
In this manual, descriptions are based on the screen display and operations of the product with au Nano IC Card 04 LE installed.
Illustrations and screens shown in this manual may look different from the actual ones. In some cases minor details or a part of a screen may be omitted.
* In this manual, descriptions are written on the assumption that you are skilled in basic operations of Windows PC/Mac, smartphones, etc. For operations of your PC or smartphone, refer to the manual of the PC or the smartphone.
* In this manual, explanations for body color "Black&Blue" are given as examples.
* In this manual, "au Nano IC Card 04 LE" is referred to as "au IC card".
* Company names and product names referred to in this manual are trademarks or registered trademarks of respective companies. The TM marks or ® marks may be omitted in the description.
* Reproduction of the content of this manual in part or in whole is prohibited.
* The content of this manual is subject to change without notice.
* Every effort has been made in the preparation of this manual. Should you notice any unclear points, omissions, etc., feel free to contact us.

What you can do with Speed Wi-Fi NEXT W06

The product can be connected to multiple wireless LAN (Wi-Fi[®]) devices such as PC, smartphone, etc. via wireless LAN (Wi-Fi[®]) and connect a PC etc. using a USB cable (sold separately/commercially available). Also the data communication by Internet access using WiMAX 2+, LTE or UMTS system is available (best effort¹⁾) on devices connected to the product.

- *1: Communication speed may not reach the maximum value depending on connection environment.
- * The product automatically determines the most suitable network at that time to connect.

■ Connecting via wireless LAN (Wi-Fi[®])

In this manual, how to connect a PC, smartphone, etc. via wireless LAN (Wi-Fi[®]) is described.
* Up to 16 devices can be connected at the same time.



■ Connecting with USB cable

You can connect the product to a PC using a USB cable (sold separately/commercially available). Using a device supporting USB 3.0 or more standards and USB cable (sold separately/commercially available) is recommended for stable high speed communication.
* Installing Speed Wi-Fi NEXT setting tool into a PC is required. The installation can be performed when connecting the product to a PC.
* Wireless LAN (Wi-Fi[®]) and USB connection can be used simultaneously. Up to 17 devices can be connected in total.



■ au World Service

You can perform data communication using LTE/UMTS network overseas.

Setting communication mode (WAN)/Performance settings

■ Setting communication mode (WAN)

You can perform data communication via WiMAX 2+, LTE or UMTS system with the product. You can select from the following communication modes to use in Japan.

	WiMAX 2+	LTE
High Speed Mode	○	—
High Speed Plus Area Mode	○	○

- * Monthly data usage amount for each communication mode differs depending on your billing plan.
- * By default, it is set to "High Speed Mode". Note that additional fee may be applied depending on your billing plan if you switch it to "High Speed Plus Area Mode".
- * For setting communication mode (WAN), see "Changing the settings" in this manual.

■ Performance settings

You can set a balance between the product performance such as communication speed etc. and the power consumption. You can select from the following modes.

High performance	Maximizes performance. It uses carrier aggregation ¹⁾ .
Smart	Carrier aggregation ¹⁾ is used when the battery level is sufficient, but not used when the battery level is low. The mode switches having an appropriate balance between performance and lasting battery when no communication status continues for the fixed time.
Battery save	Reduces battery consumption to save duration of the battery. It does not use carrier aggregation ¹⁾ .

- *1: The feature improves communication speed and performs stable high speed communication by using multiple frequency bands of radio waves at the same time.
- * Even if "High performance" or "Smart" is set, carrier aggregation may not be available depending on congestion situation of the base station etc.
- * The following settings can place more importance on the performance.
 - Turn on "4x4MIMO switch" (Except "Battery save mode")
 - Use USB connection with a device supporting USB 3.0 or more standards and USB cable (sold separately/commercially available)
- * Default setting is "Smart". To change the mode, tap "Performance settings" in the Home screen → Tap "Smart" and select the mode →

Useful features of Speed Wi-Fi NEXT W06

■ Auto mode settings

When data usage amount reaches to a specified value while communicating in High Speed Plus Area Mode, the product automatically switches the mode from High Speed Plus Area Mode to High Speed Mode.

* If you turn on Auto mode settings when WAN is set to "High Speed Mode", the communication mode will switch to "High Speed Plus Area Mode". Note that additional fee may be applied depending on your billing plan.

■ Data count

You can check data usage amount for each communication mode.
* Data usage amount is counted by the product main unit as a guide. It differs from the actual data amount that you used.

■ "HUAWEI HiLink" app

Install "HUAWEI HiLink" app to your smartphone so that you can connect the product by scanning the QR code. After connection to the product, log in to the app as administrator so that you can check the status of the product or set some functions.



- * You can download "HUAWEI HiLink" app by scanning the QR code on the right.
- * If you are already a user of "HUAWEI HiLink" app, update to the latest version before using.

■ Best Position

You can check the detailed signal strength in a place where the product is installed using "Best Position" feature of "HUAWEI HiLink" app.

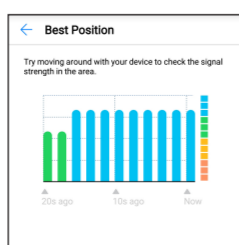

■ Wi-Fi copy settings

You can copy the settings of Wi-Fi router which you used so far to the product. Changing the settings on wireless LAN (Wi-Fi[®]) devices are not needed so that you can connect them simply.

* For details, see "Connecting by using Wi-Fi copy settings" in this manual.

■ Communication time (in Performance settings)

You can check estimated communication time calculated from the battery level for each mode of performance setting.

* It may differ from the actual communication time depending on connection status, environment, etc.

About Instruction Manual

■ **Quick Start Guide (This manual)**
Main operations for the main features are explained.

■ **取扱説明書 詳細版 (Full instruction manual) (Japanese)**
取扱説明書 詳細版 (Full instruction manual) (Japanese) which describes the detail explanations for various functions is available on the au homepage.
https://www.au.com/support/service/mobile/guide/manual/
• **取扱説明書 詳細版 (Full Instruction Manual) (Japanese)** is also installed in the product.
Connect the product to a PC etc. via wireless LAN (Wi-Fi[®]) or USB cable (sold separately/commercially available) → Activate a web browser → Enter "http://speedwifi-next.home" → Login → "Help" → "Please refer to the manual"
* For instructions on how to log in, refer to "Activating Speed Wi-Fi NEXT setting tool" in this manual.

Names and functions of parts

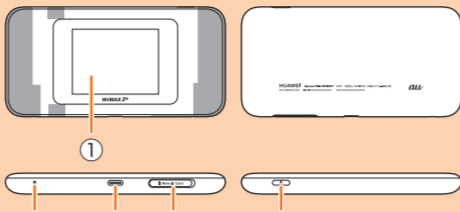

* The antenna is built into the main unit. Covering around the antenna area (Gray (■) part) with your hand may affect the communication quality.
* The exterior case cannot be removed. Do not attempt to remove it forcibly. It might cause a malfunction. Also, the battery is built into the product and not removable by customers.

■ Power button operations

Function	Operation	Description
Power on	Press for over approximately three seconds	When the power is turned off, press to turn the power on.
Power off/Reboot	Press for over approximately one second	When the power is turned on, select "Power off"/"Reboot".
Turn the display on/off Return from Wi-Fi auto sleep function ¹⁾	Press (within approx. one second)	Press to turn off the display when the power is on. Press to turn on the display when the display off; the unlock screen appears. When wireless LAN (Wi-Fi [®]) is disconnected by Wi-Fi auto sleep function ¹⁾ , press the button to resume the wireless LAN (Wi-Fi [®]) connection.
Forcibly power off	Press for over approximately ten seconds	Turn the power off forcibly when the product becomes inoperative, etc.

*1: When data communication is not performed for the set time duration, deactivate wireless LAN (Wi-Fi[®]) function to save the internal battery power.

Attaching au IC card

Your phone number etc. is recorded in the au IC card. The product is compatible with au Nano IC Card 04 LE. Although the phone number is stored to the au IC card as customer information, making/receiving calls etc. is not available with the product.
* Note the following points, otherwise handling the au IC card may cause malfunction or damage.
• Do not touch the IC (metal) part of the au IC card
• Insert in the correct direction.
• Do not force to attach or remove.

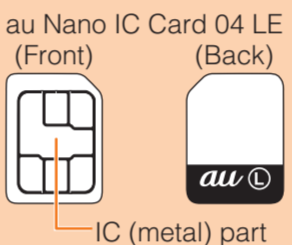

Before attaching/removing the au IC card, turn the power of the product off. au IC card is not recognized on the product if it is attached without turning off the power.
Remove a USB cable (sold separately/commercially available) if it is connected.

1 Open Nano IC Card slot cover

Put your finger (nail) on the concave part on the side of the cover and pull in the direction of the arrow.

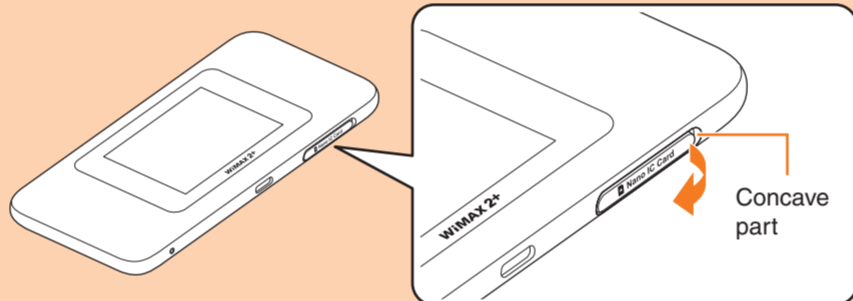

2 Insert au IC card into the Nano IC Card slot

With the IC (metal) part of the au IC card facing up, confirm the orientation with the notch as shown in the illustration, then insert the au IC card until it clicks.

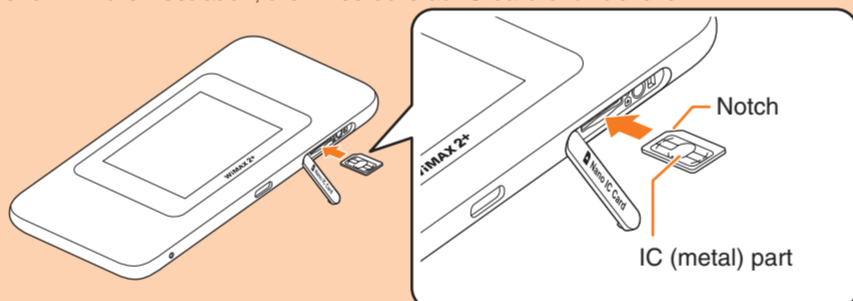

3 Align the Nano IC Card slot cover with the Nano IC Card slot

4 Gently press the Nano IC Card slot cover

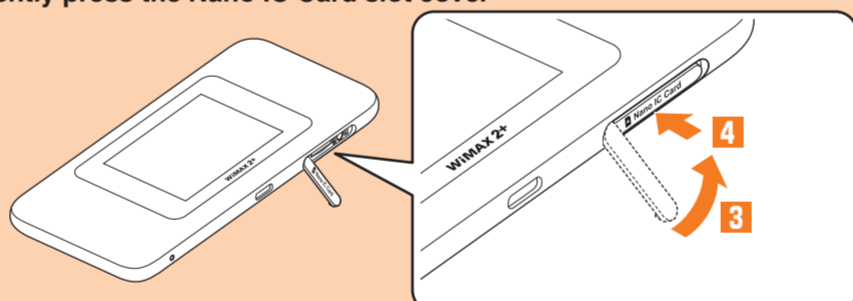

* To remove the au IC card, gently push the au IC card until it clicks, let it back without releasing your finger, and then gently pull out the au IC card. Please be careful not to lose the au IC card after it is removed.

Charging

The battery is not sufficiently charged at the time of purchase. Charge the battery before using the product.

When charging, be sure to use the specified charging equipment. Failure to do so might cause a malfunction.

Charging using TypeC Common AC Adapter 02 (sold separately) is explained here.

1 Insert a power plug of TypeC Common AC Adapter 02 (sold separately) to a power outlet of 100V AC

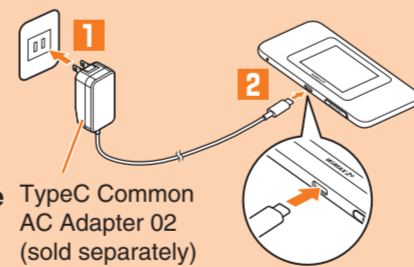

2 Connect the USB Type-C plug of TypeC Common AC Adapter 02 (sold separately) into the external connection terminal of the product

Insert it straight. Firmly insert it all the way.

3 When charging is complete, pull out the USB Type-C plug of TypeC Common AC Adapter 02 (sold separately) straight from the product

* For charging with Common AC Adapter 05 (sold separately) or by connecting to a PC using a microUSB cable (commercially available), use USB Type-C to Micro B adapter (sample) to adapt the connector shape and then connect to the external connection terminal of the product.

Turning the power on

1 Press the power button for over approximately three seconds

The power is on and the unlock screen is displayed.
• When the power is turned on, the product automatically connects to the Internet. Or, wireless LAN (Wi-Fi[®]) feature is turned on and appears.



2 Slide right

The screen is unlocked and the Home screen is displayed.
• When you power on the product for the first time, the initial setting wizard appears. See "Making initial settings" in this manual.

* To turning the power off, press the power button for over approximately one second and then tap "Power off".

Switching to English display

1 From the Home screen, 設定 (Settings) → システム設定 (Tools) → 言語 (Language) → Select "English" →

Basic operation

■ Using the touch panel

Tap

Gently touch the screen and then immediately release your finger.



Drag

Keep touching a slider etc., trace it to the desired location.



Flick (Swipe)

Operate the screen by quickly moving (flicking) your finger up/down or right/left.



Slide

Keep touching the screen and trace it to the desired direction to move over.



■ Screen display

The following information is shown on the Home screen.

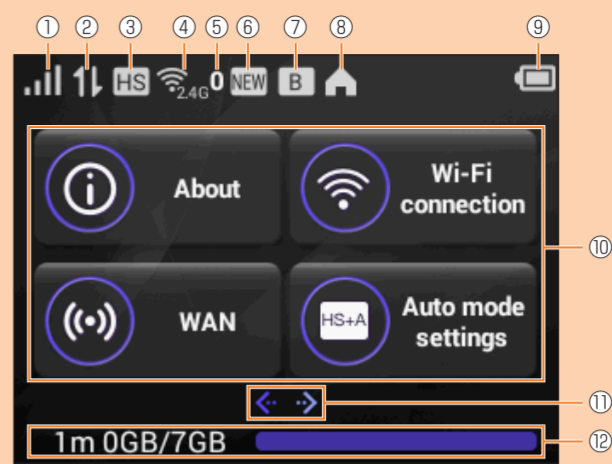

① Signal strength

: Signal strength of WiMAX 2+, LTE, or UMTS system
: No au IC card, or invalid IC card
 (Out of service area): Out of network service area

② Data communication status

: Receiving
: Sending

③ Communication mode

: High Speed Mode
: High Speed Plus Area Mode¹⁾
: Auto mode settings ON¹⁾

④ Frequency band

: 2.4 GHz band in use
: 5 GHz band in use

⑤ Number of connected wireless LAN (Wi-Fi[®]) devices

: The latest software update available

⑦ In Bridge mode

Turn on: On
Turn off: Off

⑧ Indoor use indicator

When this indicator is turned on, use the product indoors.
Turn on: Connected via wireless LAN (Wi-Fi[®]) 5 GHz band W52 channel
Turn off: Connected via wireless LAN (Wi-Fi[®]) 5 GHz W56 channel or wireless LAN (Wi-Fi[®]) 2.4 GHz band
 (Blinking): DFS checking²⁾

⑨ Battery level

: Sufficient
 (animation): Charging

⑩ Touch menu icon

Tap to make settings for each function.

⑪ Current screen indicator

Indicates which of Home screen 1 or 2 is displayed.
Home screen 1: About/Wi-Fi connection/WAN/Auto mode settings
Home screen 2: Eco settings/Performance settings/Data count/Settings

⑫ Data usage amount up to now/Max data usage specified in Data settings³⁾

1m: Display data usage for one month
3d: Display data usage for three days until today.

*1: Note that additional fee may be applied depending on your billing plan for communication in High Speed Plus Area Mode.

*2: When connecting via wireless LAN (Wi-Fi[®]) 5 GHz outdoor, the product performs channel check (DFS check) and the network connection is not available until it ends.

*3: When 1 Month display is set with Reminder setting enabled, the bar color changes if the data usage amount exceeds the specified value. When 3 Days display is set, the bar color changes if the data usage amount until the previous day exceeds the specified value.

■ Notification by animation/message

Communication status and information of failure are notified by animation or message.

■ Learning basic operation

To select displayed item or icon, directly tap the screen.

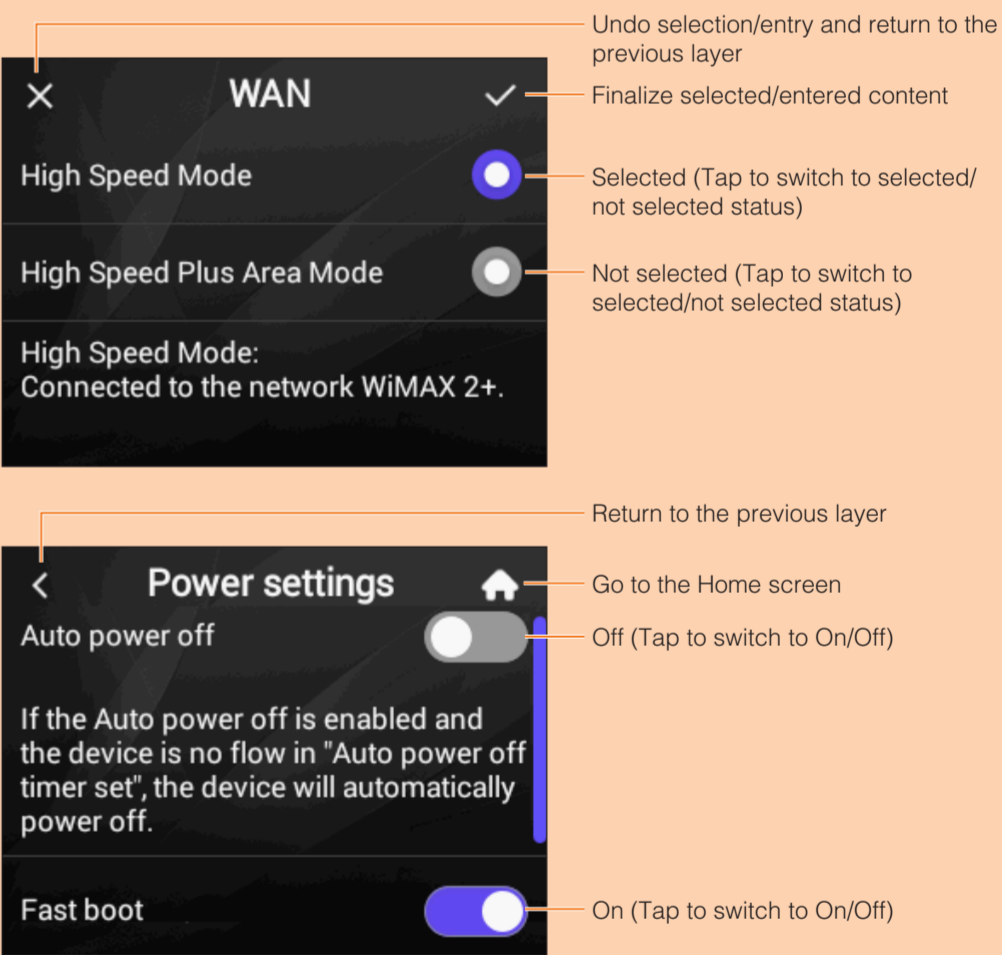

Changing the settings

The explanation is switching the communication modes as an example.

1 From the Home screen of the product, tap "WAN"

2 Tap "High Speed Mode"/"High Speed Plus Area Mode" →

* When "High Speed Plus Area Mode" is selected, "Note" screen appears. Confirm the content and tap "OK" →



* By default, it is set to "High Speed Mode". Note that additional fee may be applied depending on your billing plan if you switch it to "High Speed Plus Area Mode".

Making initial settings

When you power on the product for the first time, the initial setting wizard appears. You can make basic settings of the product.

1 On the "ようこそ! (Welcome!)" screen of the product, tap "ホームへ (Go to Home)"

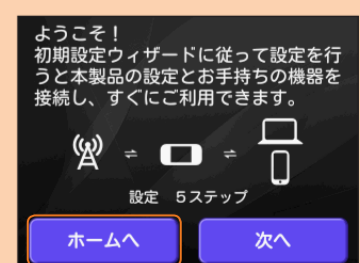

2 From the Home screen, "設定 (Settings)" → "システム設定 (Tools)" → "言語 (Language)" → Select "English" → to change the language to English

3 Tap < → "Initial setting wizard"

4 Follow the onscreen instructions to set the following items

- Step1. WAN
- Step2. Data count
- Step3. Performance settings
- Step4. Auto Update
- Step5. Wi-Fi access¹⁾

*1: For operation, see the next page.

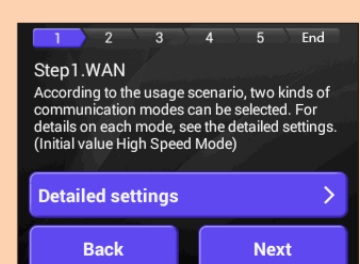

5 On the "Thank you very much!" screen, tap "OK"

The Home screen appears.

Connecting by using Wi-Fi copy settings

When using the product instead of a Wi-Fi router which you used so far, the SSID and the password can be copied to the product. Changing the settings on wireless LAN (Wi-Fi®) devices are not needed so that you can connect them simply.

* This feature is available only when WPS function is equipped on your former Wi-Fi router. Copying may not be available depending on the settings of Wi-Fi router.

1 On the Home screen of the product, tap "Wi-Fi connection" → "Wi-Fi copy settings"

- You can also set from "Step 5. Wi-Fi access" of the Initial setting wizard.
- Alternatively, from the Home screen, tap "Settings" → "Network settings" → "Wi-Fi connection" → "Wi-Fi copy settings" to start copying the setting.

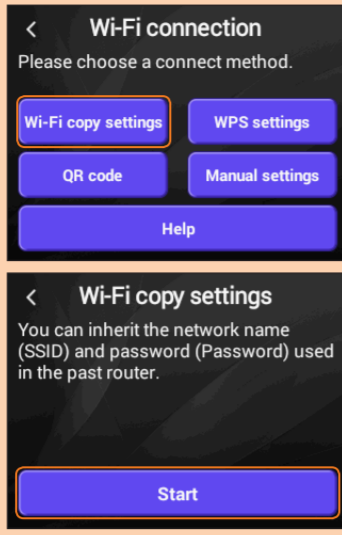

2 Tap "Start"

3 Within approximately 2 minutes, push the WPS button of the previous Wi-Fi router

When detection is succeeded, SSID, frequency (2.4 GHz/5 GHz), etc. appear on the display of the product.

- Operation varies by Wi-Fi router you used.

4 Tap "Yes"

The SSID and the password are copied to the product and the product restarts automatically.

5 When "Accomplish." appears, tap "OK"

6 Turn off the power of the previous Wi-Fi router

Your wireless LAN (Wi-Fi®) devices connect to the product.

Activating Speed Wi-Fi NEXT setting tool

You can make the product settings using Speed Wi-Fi NEXT setting tool on a web browser of your PC etc. connected to the product via wireless LAN (Wi-Fi®) or using USB cable (sold separately/commercially available). The following steps are explained for wireless LAN (Wi-Fi®) connection as an example.

* Use "SSID1" to use Speed Wi-Fi NEXT setting tool via wireless LAN (Wi-Fi®) connection. * Log in to it during the unlock screen is displayed or the screen is turned off on the product.

1 Press the power button for over approximately three seconds to turn the power on

2 Activate a wireless LAN (Wi-Fi®) device and connect to the product via wireless LAN (Wi-Fi®)

3 Activate the web browser and enter "http://speedwifi-next.home" in the URL entry field

The log-in screen appears.

4 In "言語 (Language)" field, click ▼ to open the language list and select "English", enter user name "admin" and password → "Login"

- Default login password for Speed Wi-Fi NEXT setting tool is the last five digits of IMEI shown on the bottom of the back side of the product.
- When you select "Login", a confirmation screen requesting change of password appears.

5 Select "Change Now"/"Later"

- When you select "Change Now", the password change screen appears. Follow the onscreen information to change the password and then log in with the new password.
- When you select "Later", log in with the current password.

When you log in to Speed Wi-Fi NEXT setting tool successfully, Speed Wi-Fi NEXT setting tool Settings/Connection screen appears.

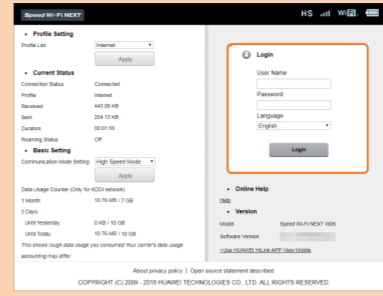

Checking own phone number etc.

You can check your device information such as phone number or IMEI.

1 From the Home screen of the product, tap "About" → "Device information"

Device information is displayed.

* Making/receiving calls etc. is not available with the product.

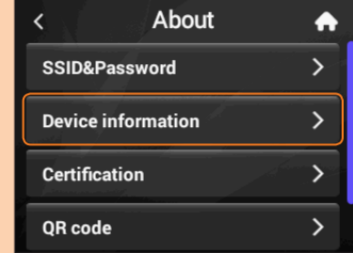

Connecting by Manual settings

You can use Manual settings of Wi-Fi connection to connect with wireless LAN (Wi-Fi®) following the onscreen instructions of the product.

* Connection is established using the product "SSID1 (WPA2/WPA)". * To set up wireless LAN (Wi-Fi®) connection, perform when connecting the product and a wireless LAN (Wi-Fi®) device for the first time. Once you set up connection, the connection for the wireless LAN (Wi-Fi®) device resumes automatically from the second time (when you set "Connect automatically", "Save the setting", etc. on the wireless LAN (Wi-Fi®) device).

1 From the Home screen of the product, tap "Wi-Fi connection"



2 Tap "Manual settings"

"Manual settings" appears. SSID and password information of the product are displayed.

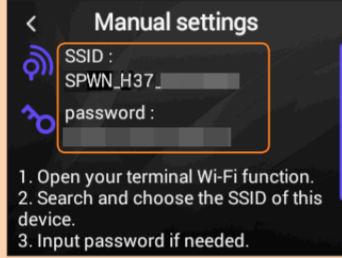

3 On a wireless LAN (Wi-Fi®) device, turn on wireless LAN (Wi-Fi®) function

4 Select the SSID of the product from the displayed network list etc.

5 Enter the security key (password)

- Confirm that the connection to the product is established on the screen of the wireless LAN (Wi-Fi®) device etc.

6 On the "Manual settings" screen of the product, "OK"

The Home screen reappears.

Wi-Fi初期設定 (Wi-Fi Initialization) sticker (Japanese)

To connect the product to a wireless LAN (Wi-Fi®) device such as a PC or smartphone via wireless LAN (Wi-Fi®), entry of network name (SSID) and security key (password) is required. The network name (SSID) and security key (password) are printed on the Wi-Fi初期設定 (Wi-Fi Initialization) sticker (Japanese) (by default). The sticker is needed to connect the product to wireless LAN (Wi-Fi®) devices after you purchased the product or reset of the product. Keep the sticker, for example, by attaching it to the included "はじめてガイド (Quick Start Guide)" (Japanese) and store it in a safe place.

Paste the sticker to this position in the included "はじめてガイド (Quick Start Guide)" (Japanese) and store it in a safe place.

Connecting with a WPS compatible wireless LAN (Wi-Fi®) device

If your wireless LAN (Wi-Fi®) device is compatible with WPS function, the wireless LAN (Wi-Fi®) device can be connected with simple steps by using WPS settings of Wi-Fi connection.

1 From the Home screen of the product, tap "Wi-Fi connection"

2 "WPS settings" → "WPS"

WPS function is enabled.

3 Perform the WPS connecting procedure on a wireless LAN (Wi-Fi®) device within approximately two minutes

When the setting is succeeded, "Wi-Fi connect success." etc. is displayed on the product screen for a short while. And the number of the counter for connected wireless LAN (Wi-Fi®) devices on the Home screen increases one.

- Operations vary by wireless LAN (Wi-Fi®) device.

Connecting with a smartphone using QR code display function

Install "HUAWEI HiLink" app on a smartphone which enables auto-connection with the product by scanning QR code displayed on the product.

1 From the Home screen of the product, tap "Wi-Fi connection" → "QR code"



2 Tap "QR code"

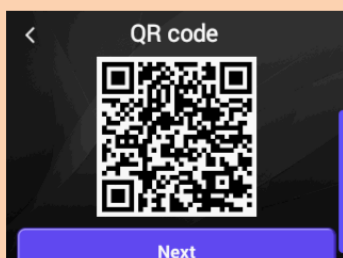

QR code for downloading "HUAWEI HiLink" app appears.

3 With a QR code scanning app of smartphone, scan the QR code for download on the display of the product to install "HUAWEI HiLink" app to the smartphone

- Install a QR code scanning app on your smartphone in advance.
- Follow the onscreen instruction of the QR code scanning app to connect the scanned URL. To download "HUAWEI HiLink" app (Play Store) <https://consumer.huawei.com/minisite/mobilewifapp/download.html>
- Confirm that "HUAWEI HiLink" app is downloaded.

4 From the app list on the smartphone, tap "HUAWEI HiLink"

- The device selection screen appears.
- When activating for the first time, "HUAWEI HiLink" app introduction appears. Follow the onscreen instructions.
- Turn on wireless LAN (Wi-Fi®) of the smartphone in advance.



5 Tap "3G/4G wireless routers" → "Later"



HUAWEI HiLink home screen appears.

6 Tap "Tools" → "Scan"

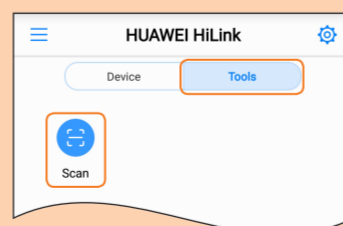

A QR code scanning screen appears.

7 On the QR code screen of the product, tap "Next"

QR code for Wi-Fi connection appears.

8 Scan the QR code for Wi-Fi connection on the screen of the product

When the wireless LAN (Wi-Fi®) signal icon is displayed on the screen of smartphone, the setting is complete.

* You can also search for "HUAWEI HiLink" app in Google Play™/App Store and download instead of scanning the QR code for download.

* Connection cannot be established automatically by scanning the QR code of the product with other than "HUAWEI HiLink" app. Be sure to use "HUAWEI HiLink" app.

* If auto-connection fails by scanning the QR code for download, see "Connecting manually" in this manual.

* For inquiries about "HUAWEI HiLink" app, contact the developer of the app or from the following homepage. <https://consumer.huawei.com/jp/support/index.htm> (Japanese)

Troubleshooting

Please check the followings if you have trouble, for example, Internet access cannot be established, etc. even after referring to this manual and making settings.

* Depending on signal condition, communication congestion, data volume of contents, etc., communication might not be performed properly. Retry in a place with a good signal condition or in another time slot.

Cannot turn the power on.

When the battery level is low, charge the battery for a while and then turn the power on.

The power unintentionally turns off.

The temperature of the internal battery may be high. Turn the power off and wait until the temperature gets low.

Cannot connect wireless LAN (Wi-Fi®) devices.

- Check if wireless LAN (Wi-Fi®) function is enabled on the wireless LAN (Wi-Fi®) device.
- When connecting with WPS function is not available, refer to manual etc. of the wireless LAN (Wi-Fi®) device. Even if connecting is failed, set wireless LAN (Wi-Fi®) function manually.
- Depending on wireless LAN (Wi-Fi®) device, connecting may fail when "Wi-Fi (PMF)" is set to ON. From "Settings" → "Network settings" → "Wi-Fi settings" and turn off "Wi-Fi (PMF)" and then retry connection.

Internet connection fails.

- Check that you are in the service area.
- Activate Speed Wi-Fi NEXT setting tool and make sure that the product connects to the Internet correctly.

Communication stops intermittently.

- Wi-Fi connection may be temporarily disconnected because of Wi-Fi auto sleep function. Press the power button of the product (within approx. one second) to restore Wi-Fi connection.
- Check the battery level. If the battery level is low, charge and then connect again.
- Check if the product and a PC etc. are correctly connected via wireless LAN (Wi-Fi®) or USB cable (sold separately/commercially available).
- When the product is connected via wireless LAN (Wi-Fi®), reboot the product.
- When the product is connected via a USB cable (sold separately/commercially available), disconnect the product from the PC and then retry connection. If connection is not established after the above-mentioned steps, disconnect the product from the PC, reboot the PC, and then connect the product again.

* If the problem persists, try resetting the product. Or try a procedure of turning off the product, removing and inserting the au IC card, and then turning on the product.

Related accessories

Accessories for charging and connecting with a PC etc. are as follows.

- TypeC Common AC Adapter 02 (0602PQA) (sold separately)
- TypeC Common AC Adapter 01 (0601PQA) (sold separately)
- Common AC Adapter 05 (0501PWA) (sold separately)¹⁾
- MicroB-TypeC Adapter (0601PHA) (sold separately)
- HUAWEI USB3.0 Cable TYPE-C/USB-A (01HWHUA) (sold separately)

*1: Use the USB Type-C to Micro B adapter (sample) to use it.

©The above accessories can be purchased from au online shop. <http://onlineshop.au.com> (Japanese)

Main specifications

Main unit

Dimensions	Approx. 128 (W)×64 (H)×11.9 (D) mm	
Weight	Approx. 125 g	
Interface	USB 3.0 High Speed (Type-C USB terminal)	
Display	2.4 inches (320×240 dots) TFT	
Power supply	5.0 V DC, 1.8A	
Internal Battery	Lithium-ion, 3.8 V, 3000 mAh	
Continuous standby time (domestic) ¹⁾	No wireless LAN (Wi-Fi®) access	Approx. 800 hours (WAN: High Speed Mode)
	Via wireless LAN (Wi-Fi®) access ²⁾	Approx. 540 minutes (WAN: High Speed Mode/Performance settings: Smart)
Continuous communication time ¹⁾	Operating ambient temperature range: 5°C - 35°C Operating ambient humidity range: 35% - 85% C (non condensing)	
Operation environment	Approx. 120 minutes (When TypeC Common AC Adapter 02 (0602PQA) (sold separately) is used) Approx. 140 minutes (When TypeC Common AC Adapter 01 (0601PQA) (sold separately) is used)	
Charging time	Approx. 120 minutes (When TypeC Common AC Adapter 02 (0602PQA) (sold separately) is used) Approx. 140 minutes (When TypeC Common AC Adapter 01 (0601PQA) (sold separately) is used)	

*1: Continuous standby time and continuous communication time change depending on your communication network.

*2: Time when one wireless LAN (Wi-Fi®) device is connected.

WAN

Compatible Networks	Domestic: WiMAX 2+, LTE Overseas: LTE, UMTS
---------------------	--

LAN

Wi-Fi®	
Compatible Networks	Wi-Fi (IEEE802.11a/b/g/n/ac-compliant)
Frequency band	2.4 GHz (1-13ch ¹⁾ , 5 GHz (W52, W56)
Secure Wi-Fi network	WEP: 64bit/128bit
	WPA-PSK: AES/AES+TKIP
	WPA2-PSK: AES/AES+TKIP
Maximum simultaneous connections	Via wireless LAN (Wi-Fi®): 16/USB connection: 1

*1: By default setting, channel can be selected between 1 and 11 ch automatically.

USB Type-C to Micro B adapter (sample)

Weight	Approx. 1.5 g
Interface	USB2.0 microB, USB3.0 TYPE-C

For inquiries

Customer Service Center

For general information, charge and operation information (toll-free)

Business hours: 9:00-20:00 (7 days a week)

From fixed-line phones: 0077-7-111 | From au mobile phones: 157 without area code

Pressing "zero" will connect you to an operator, after calling "157" on your au cellphone.

In case above numbers are not available, call (toll-free)

0120-977-033 (except Okinawa)

0120-977-699 (Okinawa)

For loss, theft or damage (Stop the service) (toll-free)

Business hours: 24 hours (7 days a week)

From fixed-line phones: 0077-7-113 | From au mobile phones: 113 without area code

In case above numbers are not available, call (toll-free)

0120-925-314

Repair and Delivery Support Center

For loss, theft, damage (toll-free)

From fixed-line phones/au mobile phones, 0120-925-919

Business hours: 9:00-20:00 (7 days a week)



Mobile phone and PHS operators collect and recycle unused telephones, batteries and battery chargers at stores bearing the logo regardless of brand and manufacturer to protect the environment and reuse valuable resources.



濡れた状態での充電は、異常な発熱・焼損などの原因となり大変危険です。



衝撃や過度な外圧を加えると、電池の破損・変形等により発熱・発火等の原因となり大変危険です。

January 2019, 1st Edition

Sold by: KDDI CORPORATION, OKINAWA CELLULAR

TELEPHONE COMPANY

Imported by: HUAWEI Technologies Japan K.K.

Manufactured by: HUAWEI TECHNOLOGIES CO., LTD.